

1825.63mm
(5'-11 7/8") dia.

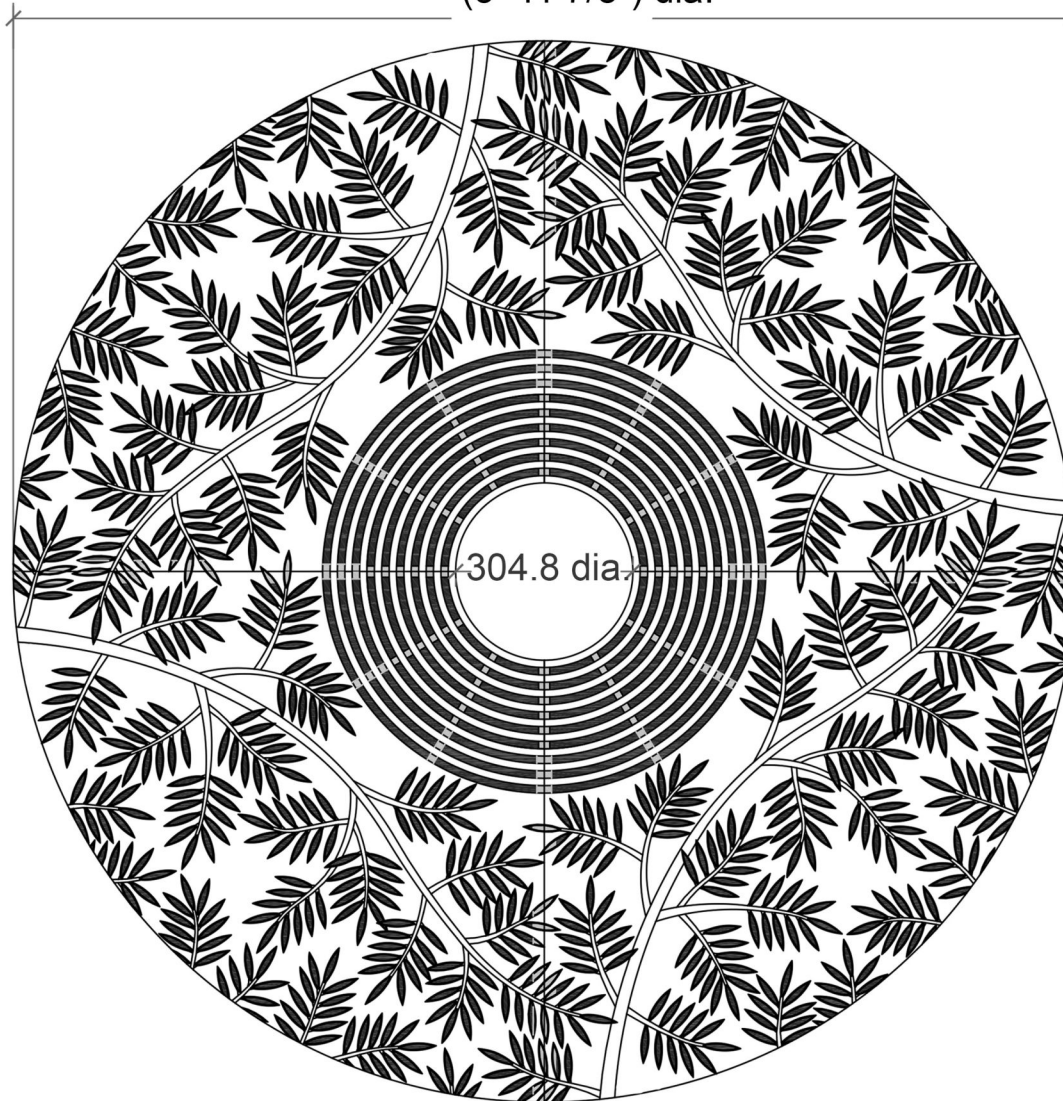

304.8 dia



Pattern : Locust

Material : Cast Iron

Finish : Natural finish

Thickness : 31.75

Dimensions : 1825,6300

Units : mm

Load Class : N/A

Flow rate : N/A

Locust 1825 mm Round Grate

Locust treegrate 6' dia.

Drawing no : LOS-TGR-1825 Product no : CI65-1825TGR

1. Due to casting inconsistencies all dimensions are nominal
2. No openings greater than 12.7mm
3. Tree opening : 304.8 mm , break - outs to 762.0 mm dia
4. Weight 470 pounds
5. Please discuss about channel drain options



www.lateraldesignstudio.co.uk

Unit 5 Cotswold Business Park
Millfield Lane
Beds LU1 4AJ

Copyright 2011-2016 Lateral Design Studio Limited. This drawing and subject matter disclosed therein, embody proprietary information which is the confidential property of Lateral Design Studio Ltd, none of which shall be copied, reproduced, disclosed to others, published or used, in whole or in part, without the express advanced written permission of a duly authorised agent of the company. This drawing is subject to recall by Lateral Design Studio Ltd.



info@lateraldesignstudio.co.uk

0208 450 2244